



Stockton-on-Tees
Application to vary a premises licence
Licensing Act 2003

For help contact
licensing.administration@stockton.gov.uk
Telephone: 01642 526558

* required information

Section 1 of 17

You can save the form at any time and resume it later. You do not need to be logged in when you resume.

System reference This is the unique reference for this application generated by the system.

Your reference You can put what you want here to help you track applications if you make lots of them. It is passed to the authority.

Are you an agent acting on behalf of the applicant? Put "no" if you are applying on your own behalf or on behalf of a business you own or work for.

Yes No

Applicant Details

* First name

* Family name

* E-mail

Main telephone number Include country code.

Other telephone number

Indicate here if you would prefer not to be contacted by telephone

Are you:

Applying as a business or organisation, including as a sole trader

Applying as an individual

A sole trader is a business owned by one person without any special legal structure. Applying as an individual means you are applying so you can be employed, or for some other personal reason, such as following a hobby.

Applicant Business

Is your business registered in the UK with Companies House? Yes No

Note: completing the Applicant Business section is optional in this form.

Is your business registered outside the UK? Yes No

Business name If your business is registered, use its registered name.

VAT number Put "none" if you are not registered for VAT.

Legal status

Continued from previous page...

Your position in the business

Home country

The country where the headquarters of your business is located.

Business Address

If you have one, this should be your official address - that is an address required of you by law for receiving communications.

Building number or name

Street

District

City or town

County or administrative area

Postcode

Country

Section 2 of 17

APPLICATION DETAILS

This application cannot be used to vary the licence so as to extend the period for which the licence has effect or to vary substantially the premises to which it relates. If you wish to make that type of change to the premises licence, you should make a new premises licence application under section 17 of the Licensing Act 2003.

I/we, as named in section 1, being the premises licence holder, apply to vary a premises licence under section 34 of the Licensing Act 2003 for the premises described in section 2 below.

* Premises Licence Number

Are you able to provide a postal address, OS map reference or description of the premises?

Address OS map reference Description

Postal Address Of Premises

Building number or name

Street

District

City or town

County or administrative area

Postcode

Country

Premises Contact Details

Telephone number

Continued from previous page...

Non-domestic rateable
value of premises (£)

0 - 4,300 Band A

Section 3 of 17

VARIATION

Do you want the proposed
variation to have effect as
soon as possible? Yes No

Do you want the proposed variation to have effect in relation to the
introduction of the late night levy?

Yes No

You do not have to pay a fee if the only
purpose of the variation for which you are
applying is to avoid becoming liable to the
late night levy.

If your proposed variation
would mean that 5,000 or
more people are expected to
attend the premises at any
one time, state the number
expected to attend

Describe Briefly The Nature Of The Proposed Variation

Describe the premises. For example the type of premises, its general situation and layout and any other information which could be relevant to the licensing objectives. Where your application includes off-supplies of alcohol and you intend to provide a place for consumption of these off-supplies, you must include a description of where the place will be and its proximity to the premises.

To extend the Cultural Quarter license area from the North of Calverts Lane to include Bishop Street up to and including Bishop Street car park. Additionally we wish to extend the licensed area from Calverts Square to include Mahujos and Mahujos Car park. We also wish to extend the license to include Silver Street.

Section 4 of 17

PROVISION OF PLAYS

Will the schedule to provide plays be subject to change if this application to vary is successful?

Yes No

Section 5 of 17

PROVISION OF FILMS

Will the schedule to provide films be subject to change if this application to vary is successful?

Yes No

Section 6 of 17

PROVISION OF INDOOR SPORTING EVENTS

Will the schedule to provide indoor sporting events be subject to change if this application to vary is successful?

<i>Continued from previous page...</i>	<input type="radio"/> Yes	<input type="radio"/> No
Section 7 of 17		
PROVISION OF BOXING OR WRESTLING ENTERTAINMENTS		
Will the schedule to provide boxing or wrestling entertainments be subject to change if this application to vary is successful?		
<input type="radio"/> Yes	<input type="radio"/> No	
Section 8 of 17		
PROVISION OF LIVE MUSIC		
Will the schedule to provide live music be subject to change if this application to vary is successful?		
<input checked="" type="radio"/> Yes	<input type="radio"/> No	
Section 9 of 17		
PROVISION OF RECORDED MUSIC		
Will the schedule to provide recorded music be subject to change if this application to vary is successful?		
<input checked="" type="radio"/> Yes	<input type="radio"/> No	
Section 10 of 17		
PROVISION OF PERFORMANCES OF DANCE		
Will the schedule to provide performances of dance be subject to change if this application to vary is successful?		
<input checked="" type="radio"/> Yes	<input type="radio"/> No	
Section 11 of 17		
PROVISION OF ANYTHING OF A SIMILAR DESCRIPTION TO LIVE MUSIC, RECORDED MUSIC OR PERFORMANCES OF DANCE		
Will the schedule to provide anything similar to live music, recorded music or performances of dance be subject to change if this application to vary is successful?		
<input checked="" type="radio"/> Yes	<input type="radio"/> No	
Section 12 of 17		
PROVISION OF LATE NIGHT REFRESHMENT		
Will the schedule to provide late night refreshment be subject to change if this application to vary is successful?		
<input type="radio"/> Yes	<input type="radio"/> No	
Section 13 of 17		
SUPPLY OF ALCOHOL		
Will the schedule to supply alcohol be subject to change if this application to vary is successful?		
<input checked="" type="radio"/> Yes	<input type="radio"/> No	

Continued from previous page...

Section 14 of 17

ADULT ENTERTAINMENT

Highlight any adult entertainment or services, activities, or other entertainment or matters ancillary to the use of the premises that may give rise to concern in respect of children.

Provide information about anything intended to occur at the premises or ancillary to the use of the premises which may give rise to concern in respect of children, regardless of whether you intend children to have access to the premises, for example (but not exclusively) nudity or semi-nudity, films for restricted age groups etc gambling machines etc.

Section 15 of 17

HOURS PREMISES ARE OPEN TO THE PUBLIC

Standard Days And Timings

MONDAY

Start

End

Start

End

Provide timings in 24 hour clock (e.g., 16:00) and only give details for the days of the week when you intend the premises to be used for the activity.

TUESDAY

Start

End

Start

End

WEDNESDAY

Start

End

Start

End

THURSDAY

Start

End

Start

End

FRIDAY

Start

End

Start

End

SATURDAY

Start

End

Start

End

SUNDAY

Start

End

Start

End

State any seasonal variations.

Continued from previous page...

For example (but not exclusively) where the activity will occur on additional days during the summer months.

Non standard timings. Where you intend to use the premises to be open to the members and guests at different times from those listed above, list below.

For example (but not exclusively), where you wish the activity to go on longer on a particular day e.g. Christmas Eve.

Identify those conditions currently imposed on the licence which you believe could be removed as a consequence of the proposed variation you are seeking.

- I have enclosed the premises licence
- I have enclosed the relevant part of the premises licence

Reasons why I have failed to enclose the premises licence or relevant part of premises licence.

Section 16 of 17

LICENSING OBJECTIVES

Describe the steps you intend to take to promote the four licensing objectives:

a) General – all four licensing objectives (b,c,d,e)

List here steps you will take to promote all four licensing objectives together.

No changes to current licensing conditions

b) The prevention of crime and disorder

No changes to current licensing conditions

Continued from previous page...

c) Public safety

No changes to current licensing conditions

d) The prevention of public nuisance

No changes to current licensing conditions

e) The protection of children from harm

Amend Challenge 21 policy to Challenge 25 policy
Update CRB stipulation to DBS

Section 17 of 17

PAYMENT DETAILS

This fee must be paid to the authority. If you complete the application online, you must pay it by debit or credit card.

Variation Fees are determined by the non domestic rateable value of the premises.

To find out a premises non domestic rateable value go to the Valuation Office Agency site at http://www.voa.gov.uk/business_rates/index.htm

Band A - No RV to £4300	£100.00
Band B - £4301 to £33000	£190.00
Band C - £33001 to £87000	£315.00
Band D - £87001 to £125000	£450.00*
Band E - £125001 and over	£635.00*

*If the premises rateable value is in Bands D or E and the premises is primarily used for the consumption of alcohol on the premises then your are required to pay a higher fee

Band D - £87001 to £125000	£900.00
Band E - £125001 and over	£1,905.00

If you own a large premise you are subject to additional fees based upon the number in attendance at any one time

Capacity 5000-9999	£1,000.00
Capacity 10000 -14999	£2,000.00
Capacity 15000-19999	£4,000.00
Capacity 20000-29999	£8,000.00
Capacity 30000-39999	£16,000.00
Capacity 40000-49999	£24,000.00
Capacity 50000-59999	£32,000.00
Capacity 60000-69999	£40,000.00
Capacity 70000-79999	£48,000.00
Capacity 80000-89999	£56,000.00
Capacity 90000 and over	£64,000.00

* Fee amount (£)

Continued from previous page...

ATTACHMENTS

AUTHORITY POSTAL ADDRESS

Address

Building number or name	PO Box 232
Street	16 Church Road
District	
City or town	Stockton on Tees
County or administrative area	
Postcode	TS18 1XD
Country	United Kingdom

DECLARATION

* I/we understand it is an offence, liable on conviction to a fine up to level 5 on the standard scale, under section 158 of the licensing act 2003, to make a false statement in or in connection with this application.

Ticking this box indicates you have read and understood the above declaration

This section should be completed by the applicant, unless you answered "Yes" to the question "Are you an agent acting on behalf of the applicant?"

* Full name	Reuben Kench	
* Capacity	Director of Culture, Leisure & Events	
Date (dd/mm/yyyy)	24/05/17	

Add another signatory

Once you're finished you need to do the following:

1. Save this form to your computer by clicking file/save as...
2. Go back to <https://www.gov.uk/apply-for-a-licence/premises-licence/stockton-on-tees/change-1> to upload this file and continue with your application.

Don't forget to make sure you have all your supporting documentation to hand.

IT IS AN OFFENCE, LIABLE ON SUMMARY CONVICTION TO A FINE NOT EXCEEDING LEVEL 5 ON THE STANDARD SCALE, UNDER SECTION 158 OF THE LICENSING ACT 2003, TO MAKE A FALSE STATEMENT IN OR IN CONNECTION WITH THIS APPLICATION

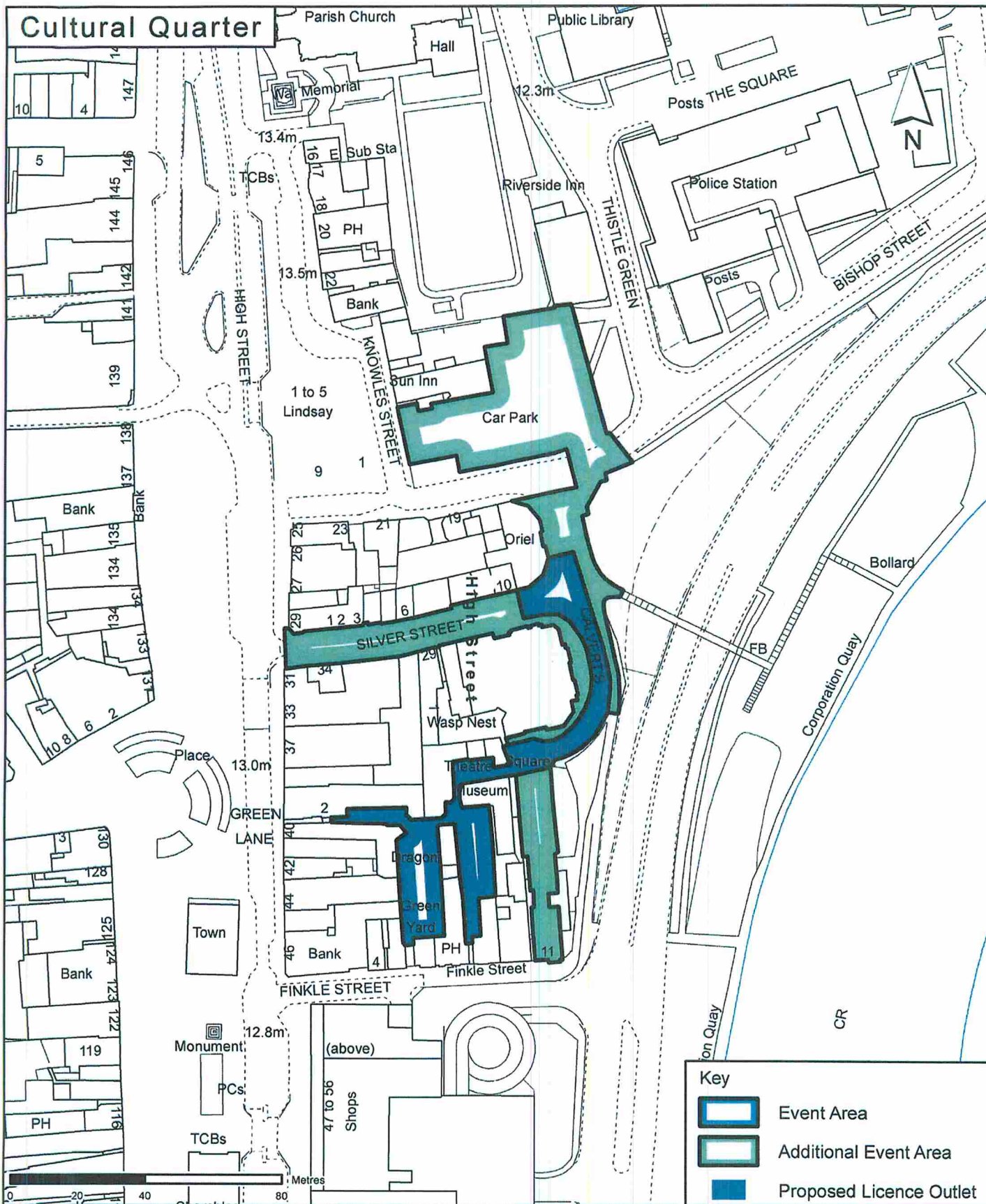

Key

- Event Area
- Additional Event Area
- Proposed Licence Outlet

Stockton-on-Tees
BOROUGH COUNCIL

Ref. G:\Apps\MG\aa_m\events
File: licence_for_Cultural Quarter_May_2017.mxd

Title. **Stockton Cultural Quarter**
Licenced and Events Areas

Development & Neighbourhood Services

Head of Culture and Leisure: R. Kench,
Municipal Buildings, Church Road,
Stockton-on-Tees, TS18 1LE.
Telephone: (01642) 393939

Date. **May 2017**

© Crown copyright and database right 2017.
Ordnance Survey Licence Number 100023297.

Scale. **Not To Scale.**